

INSTALLATION SPCE(TOP)

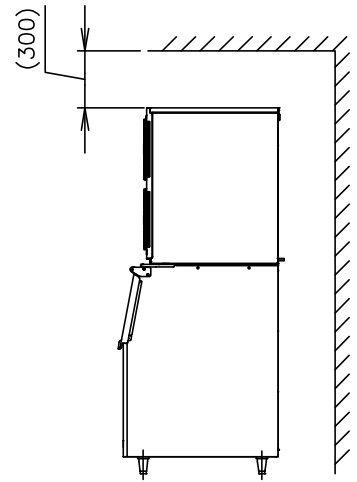

INSTALLATION SPCE(SIDE)

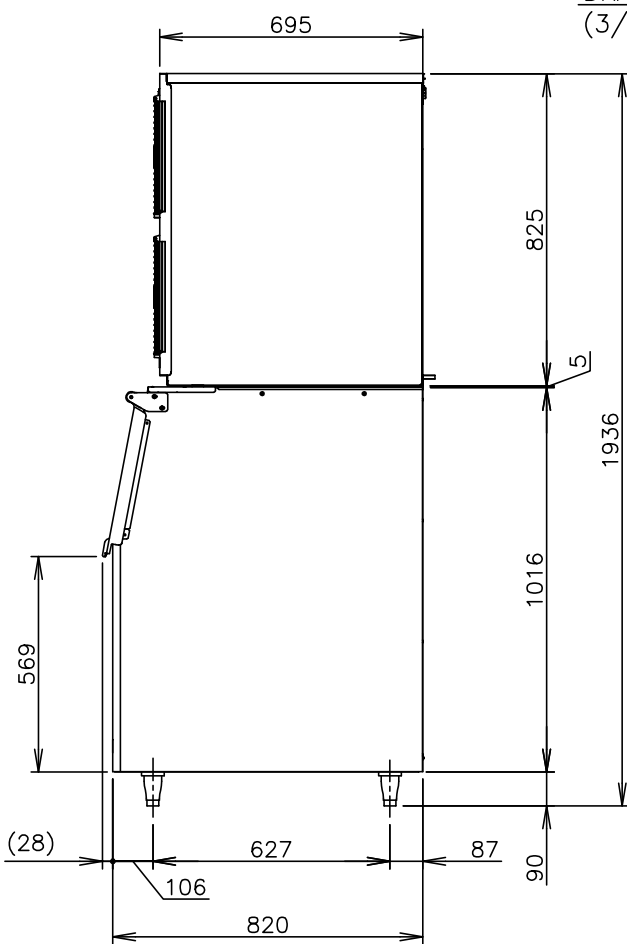
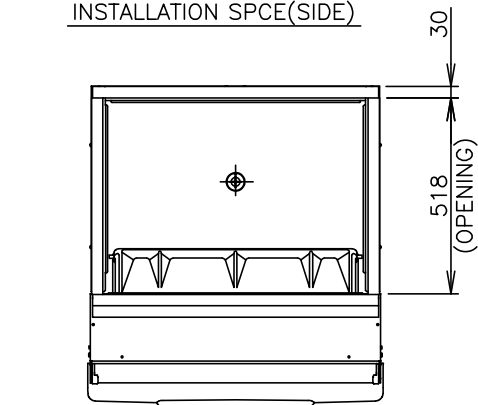
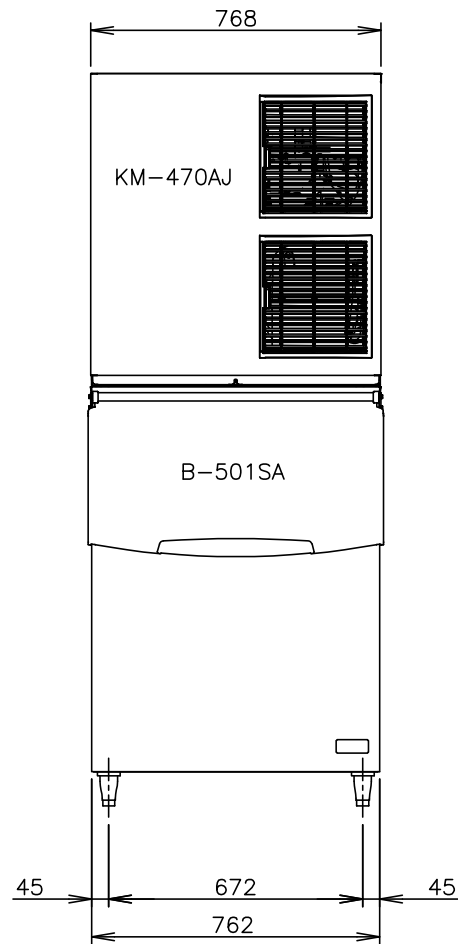
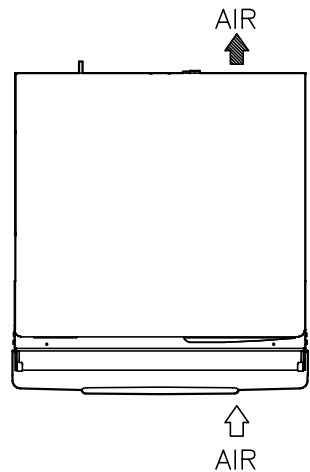

WEIGHT	ICE MAKER: Net weight 122kg / Gross weight 136kg STORAGE BIN: Net weight 47kg / Gross weight 57kg
PACKAGE	ICE MAKER: Carton 855mm (W) x 843mm (D) x 983mm (H) STORAGE BIN: Carton 866mm (W) x 924mm (D) x 1138mm (H)
ACCESSORIES	Instruction Manual, Universal Brace(2) Bolt(2), thumbscrew(2)
OPERATION CONDITION	Ambient Temp. : 7-38°C, Water Supply Temp. : 7-32°C Water Supply Pressure: 0.07-0.78MPa (0.7-7.8bar) Voltage Range: 198-254V

- *We reserve the right to make changes in specifications and design without prior notice.
1. Install the product properly in accordance with the instructions on location, water supply / drain connections and electrical connections stated in the instruction and installation manuals provided. Allow 10mm extra space at the installation site to meet any installation requirements (additional spacing is also required for proper pipe connections).
 2. The ice production depends on the ambient and water temperatures. Refer to the instruction manual.
 3. These specifications are applicable to the products with auxiliary code H0 and before.
 4. Product Code: F136, F136-C301, F136-D001, F136-D301, F136-D201 (ICEMAKER)
G007 (STORAGE BIN)

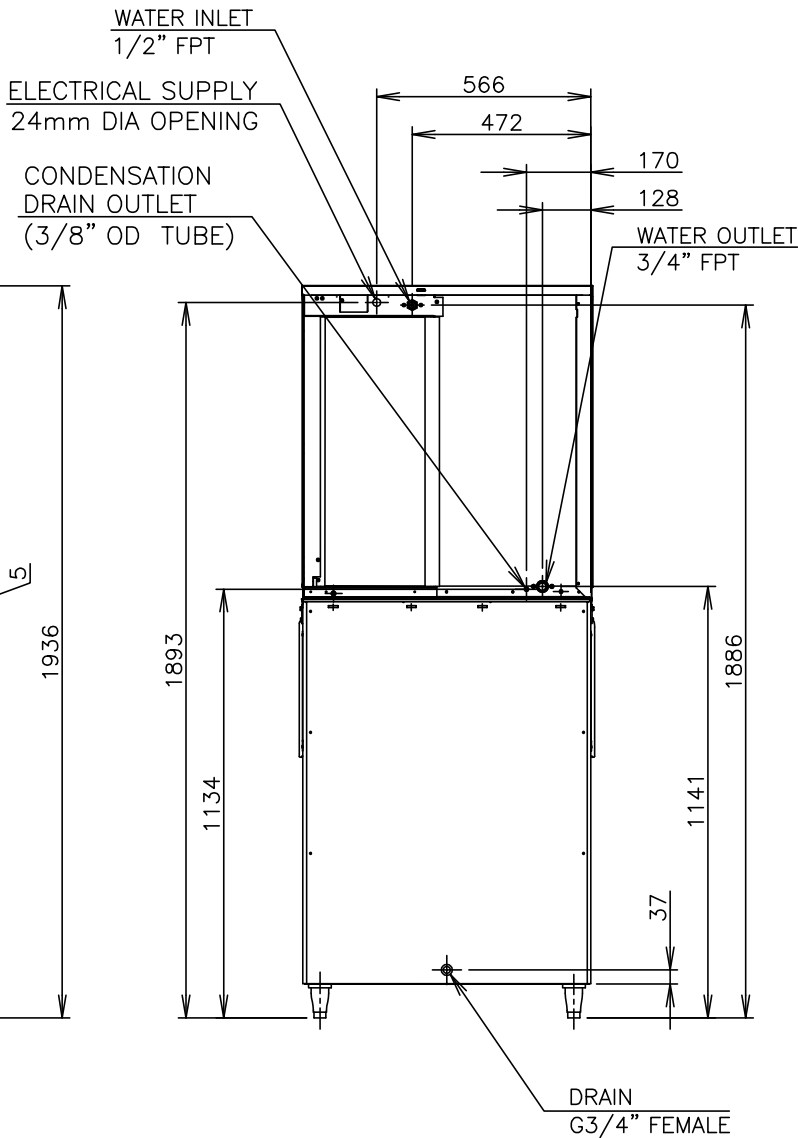

ITEM	Hoshizaki Crescent Ice Maker (Modular Type)
MODEL	KM-470AJ-B-501SA
POWER SUPPLY	1 Phase 220-240/220-230V 50/60Hz Capacity: Min. 3.45/3.51kVA (15.0/15.2A)
AMPERAGE	Running: 11.2/12.5A Rated Motor: 11.2/12.5A Starting: 55/56A
ELECTRIC CONSUMPTION	Rated Motor: 1,850/1,910W (Power factor: 71/66%)
ICE PRODUCTION PER 24h	Approx. 495/505kg/d (AT. 10°C, WT. 10°C) Approx. 480/490kg/d (AT. 21°C, WT. 15°C) Approx. 380/390kg/d (AT. 32°C, WT. 21°C)
WATER CONSUMPTION PER 24h	Approx. 1.87/2.20m³/d (AT. 10°C, WT. 10°C) Approx. 1.02/1.01m³/d (AT. 21°C, WT. 15°C) Approx. 0.65/0.52m³/d (AT. 32°C, WT. 21°C)
STORAGE CAPACITY	Approx. 173kg Maximum 217kg
SHAPE OF ICE	Crescent Cube
FREEZE CYCLE TIME	Approx. 24/23.4Min (AT. 21°C, WT. 15°C)
ICE PRODUCTION PER CYCLE	Approx. 9.7/9.1kg/960pcs (AT. 21°C, WT. 15°C)
OUTSIDE DIMENSIONS	762mm (W) x 820mm (D) x 1936 (-1966)mm (H)
EXTERIOR	Stainless Steel, Galvanized Steel (Rear)
STORAGE BIN	EXTERIOR Stainless Steel, Galvanized Steel (Rear) INTERIOR Plastic Door Polyethylene
INSULATION FOAM BLOWING AGENT	ICE MAKER: Cyclopentane STORAGE BIN: Cyclopentane
CONNECTIONS - ELECTRIC	PERMANENT CONNECTION(CONDUIT)
CONNECTIONS - WATER SUPPLY	Inlet 1/2"FPT (connected at rear side)
CONNECTIONS-DRAIN	Outlet 3/4"FPT (connected at rear side)
CONNECTIONS - CONDENSATE DRAIN	3/8" OD TUBE
ICE MAKING SYSTEM	Vertical Evaporator with water flow on both sides
HARVESTING SYSTEM	Water Supply Harvest Cycle and Hot Gas Defrost
COMPRESSOR	Hermetic
CONDENSER	Air-cooled, Fin and Tube type
EVAPORATOR	Vertical type, Stainless Steel and Copper
REFRIGERANT CONTROL	Thermostatic Expansion Valve
REFRIGERANT	R404A/1,400g
ICE MAKING CONTROL SYSTEM	Float Switch
HARVESTING CONTROL SYSTEM	Hot Gas and Water, Thermistor and Timer
ICE MAKING WATER CONTROL SYSTEM	Timer Controlled, Overflow Pipe
BIN CONTROL SYSTEM	Thermostat
ELECTRICAL PROTECTION	Class I Appliance, 10A Fuse
P.C. BOARD CIRCUIT PROTECTION	High Voltage Cut-out (Internal)
COMPRESSOR PROTECTION	Auto-reset Overload Protector (Internal)
REFRIGERANT CIRCUIT PROTECTION	Auto-reset High Pressure Control Switch
LOW WATER PROTECTION	Float Switch